

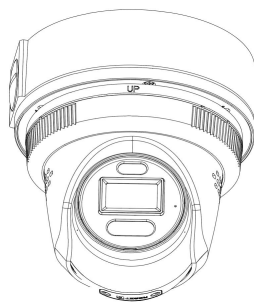

JB05 & TF2/TV2/TF4

INSTALLATION GUIDE



V1.0.0

APPEARANCE



AC-JB05

INSTALLATION

1. Stick the mounting template to the wall where the junction box will be installed. Then drill the holes as marked on the template.

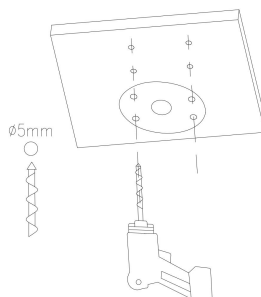

2. Insert the expansion bolts into the drilled holes and tap them in with a hammer.

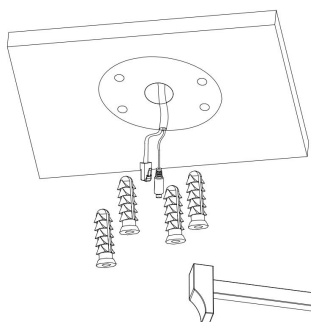

3. Loosen the screws that come with the junction box, as shown below.

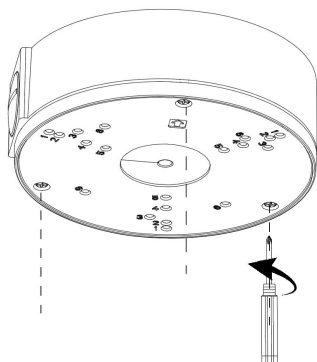

4. Thread the tail wire through the hole of the junction box, tighten the 4 screws with black rubber ring pads to fix the junction box on the wall.

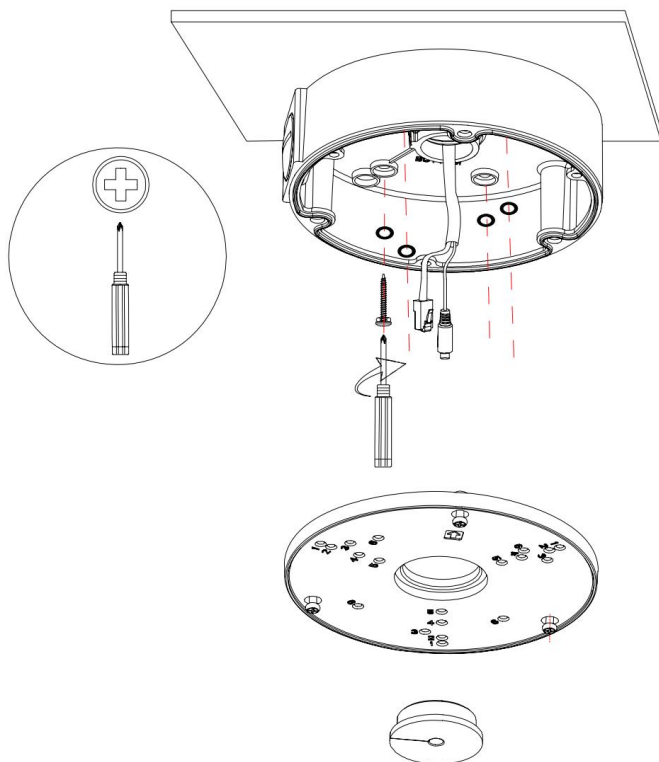

5. Thread the tail wire through the hole of the cover, fix the cover on the junction box.

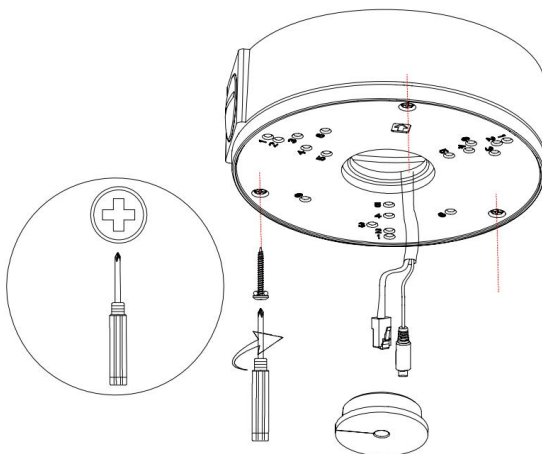

6. Connect the camera's tail cable and put the cable back into the junction box through the round hole. (The round hole has enough space for plugging the wire).

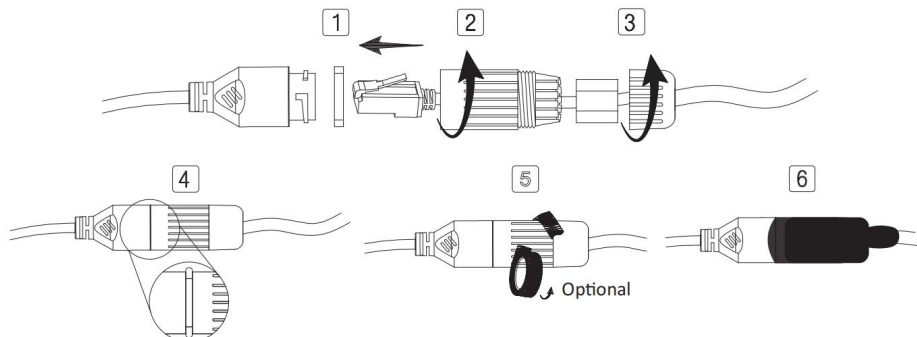

Note: Tighten until the sealing ring is push out.

Please refer to the steps bellow to complete the RJ45 cable waterproof.

Steps:

- 1) Attach the seal ring to the copper interface and insert the cable into the Ethernet copper interface.
- 2) Screw the waterproof bolt in.
- 3) Screw in the waterproof bolt lid.
- 4) Tighten until the sealing ring is push out.
- 5) Optional: Use the waterproof tape to cover the RJ45 waterproof cover.
- 6) Finish the installation.

7. Put the cable back into the junction box through the round hole. (The round hole has enough space for plugging the wire).

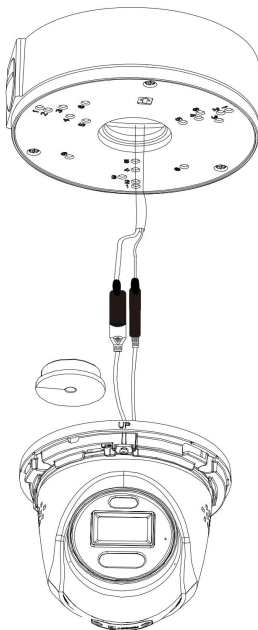

8. Put the seal plug in the junction box.

[NOTE] Please do not insert the tail cable completely into the cable compartment, in order to facilitate the adjustment of the camera angle.

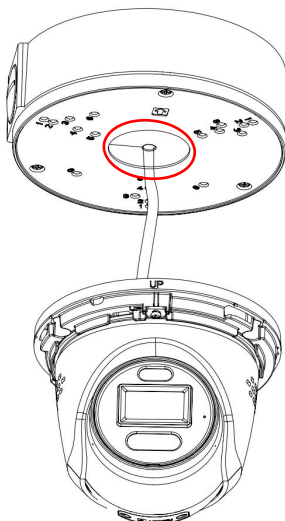

9. Match JB05 & TF2 with the three mounting screw holes, as shown bellow.

TF2 Shell Camera

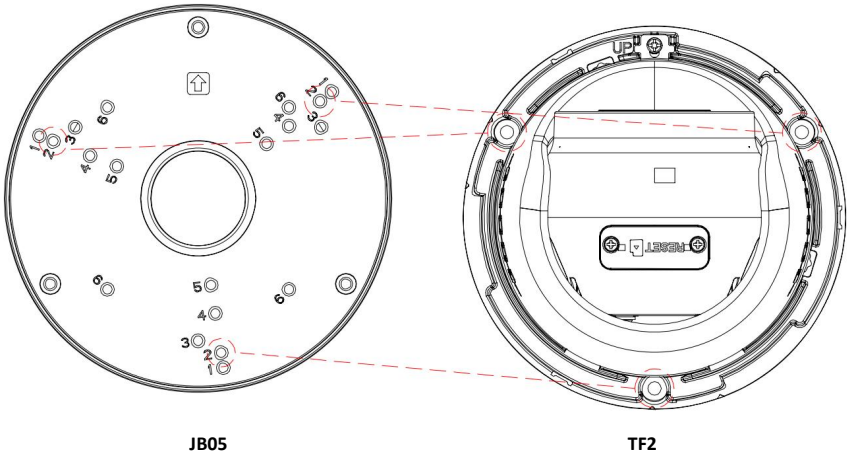

TF4 (none AD) Shell Camera

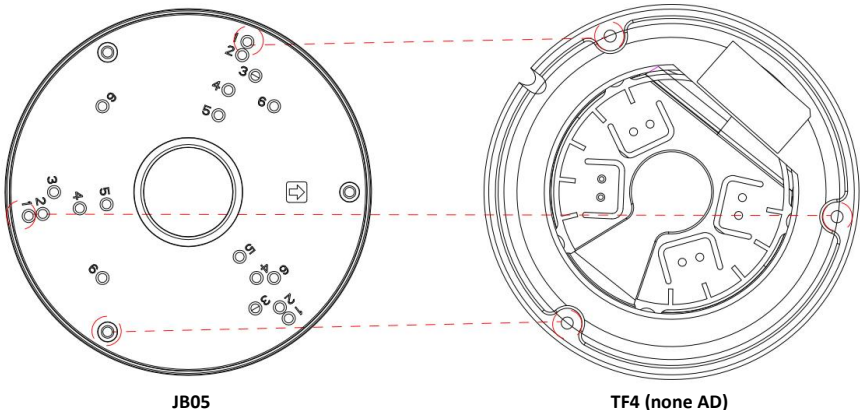

TV2/TF4 (AD) Shell Camera

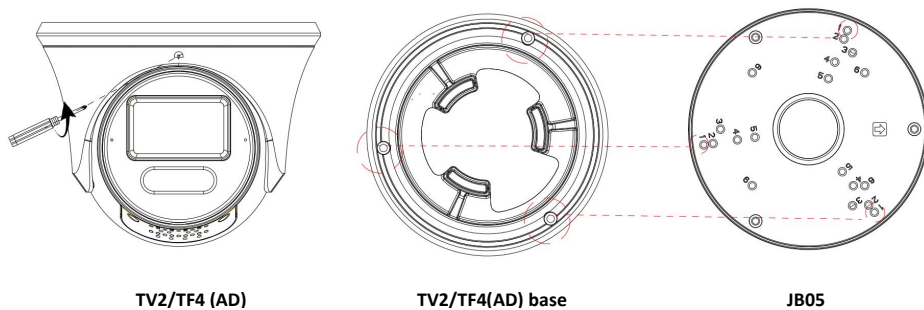

TV2/TF4 (AD)

TV2/TF4(AD) base

JB05

[NOTE] TF4 (AD) refer to TF4 shell with active deterrence camera. Please loosen the screws, separate the camera base, and then connect the number 1 holes of the junction box.

10. Tighten the screws (M4*8) to fix TF2 camera to the junction box.

TF2 Shell Camera

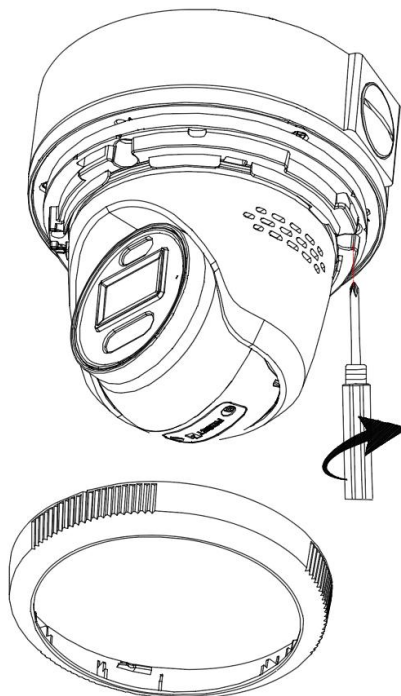

TF4 (none AD) Shell Camera

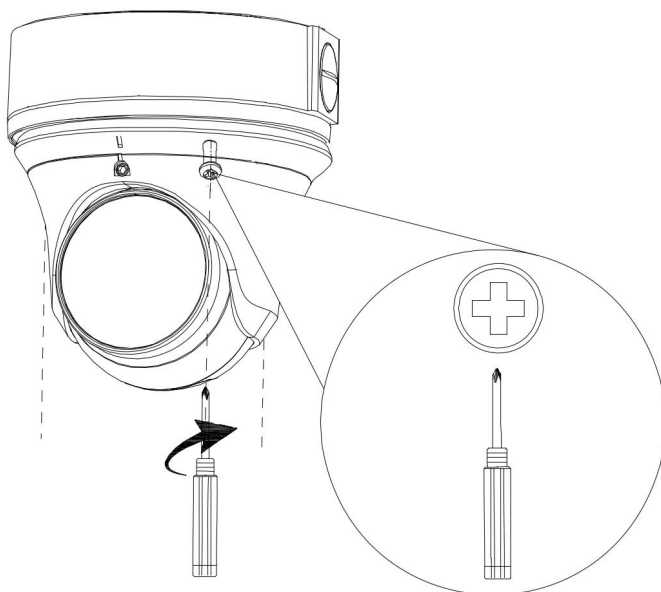

TV2/TF4 (AD) Shell Camera

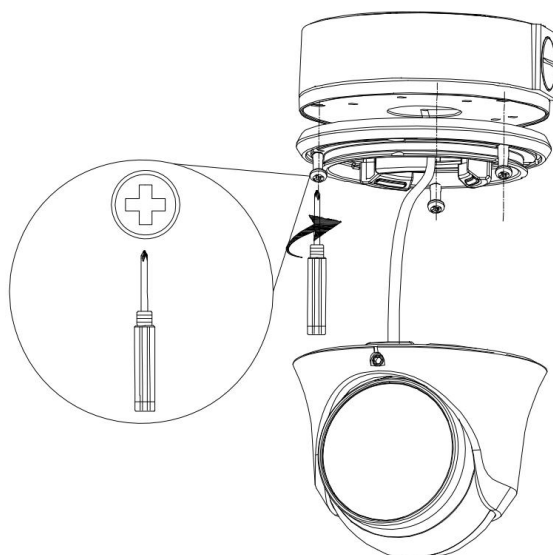

11. Align the TV2/TF4 (AD) shell camera's slot and then attach the camera to the camera base as shown below.

[NOTE] Please skip this step if your camera is **TF2** model or **TF4** (none AD) camera.

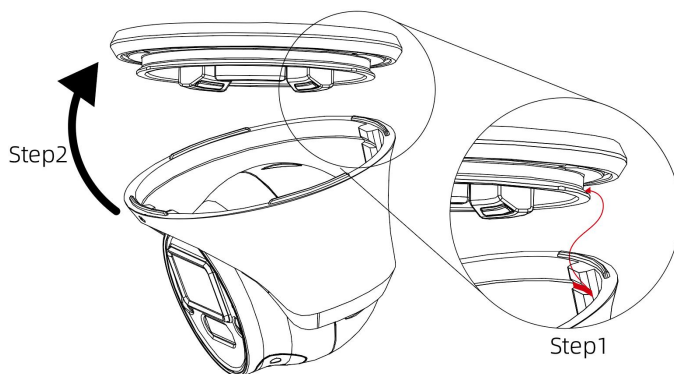

12. Power on the camera to check whether the image on the monitor is gotten from the optimum angle. If not, adjust the camera according to the figure below to get an optimum angle, and then tighten the screws or lock TF2's cover.

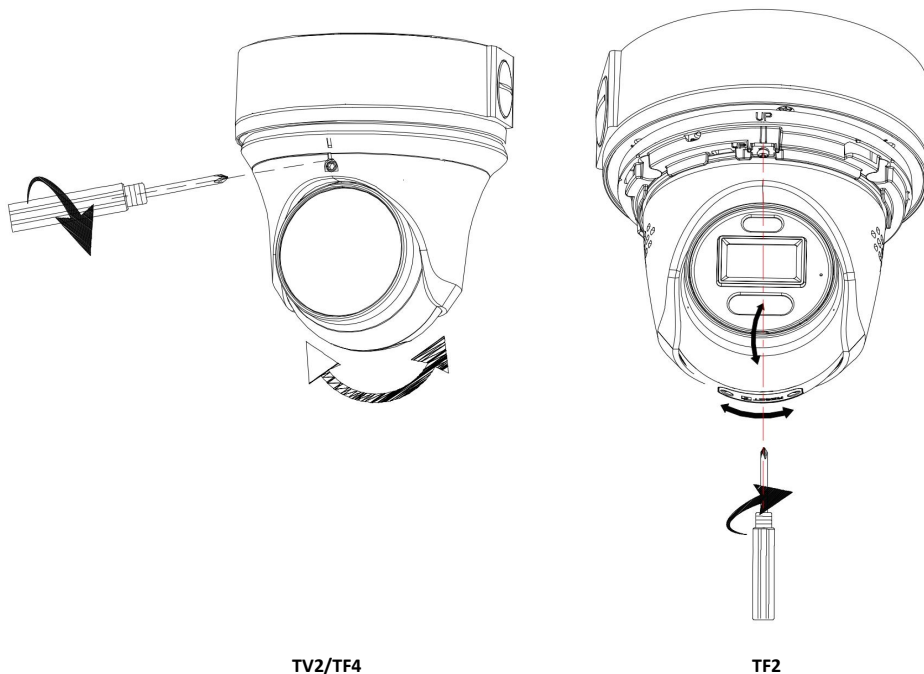

13. Turn clockwise to fix the cover and complete the TF2 installation.

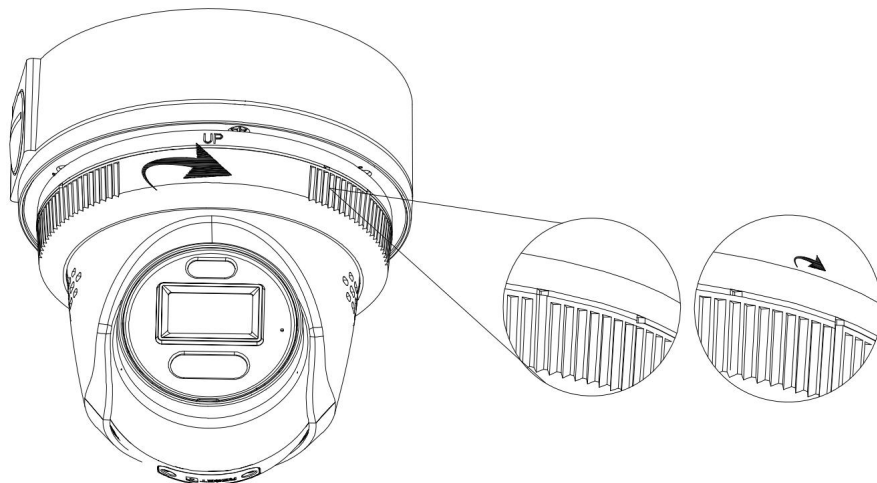

APPENDICE

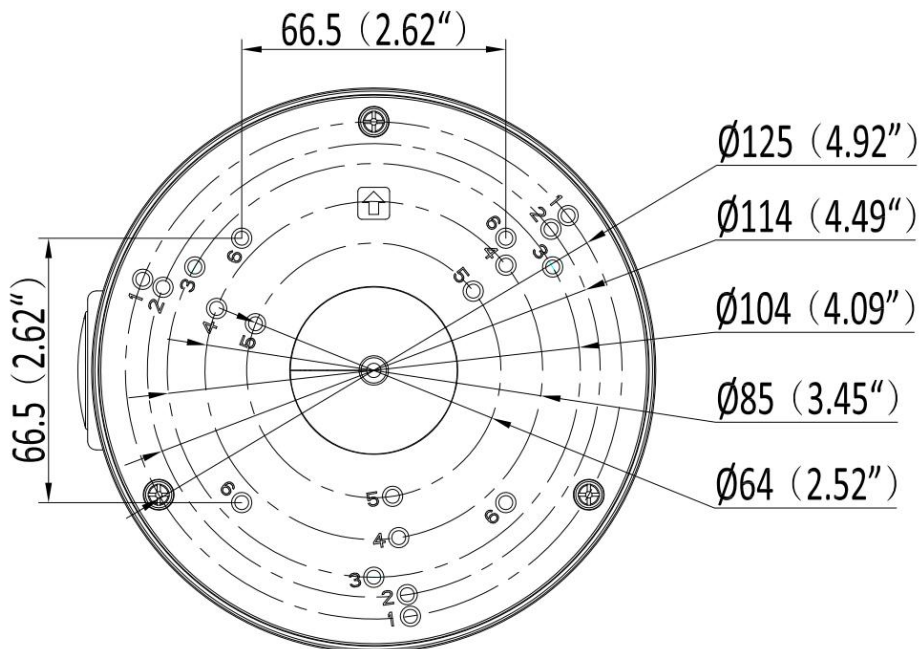

JB05

Screw Hole No. on JB05	JB05 Match Camera Shell
Screw Hole 1	TF4、TV2、DV2
Screw Hole 2	TF2
Screw Hole 3	DV4
Screw Hole 4	BF6、MSB62
Screw Hole 5	BF4、BV2